



## M SERIES 0.7-1.5t VNA truck

1	Model		FBT07-M1JZ	FBT10-M1JZ	FBT13-MJZE	FBT13S-MJZE	FBT15-MJZE	
2	Power type		Battery	Battery	Battery	Battery	Battery	
3	Type of operation		stand on	stand on	sitted on	sitted on	sitted on	
4	Load capacity	kg	700	1000	1300	1300	1500	
5	Load centre	mm	500	500	600	600	600	
6	Lift height	mm	3000	3000	5500	5500	5500	
7	Free Lift height	mm	0	0	1840	1840	1840	
8	Fork dimensions	L×W×T	mm	1070×100×35	1070×100×35	1150×122×40	1150×122×40	1150×122×40
9	Overall dimensions	Overall length(unladen)	l1(mm)	2800	2967	3468	3468	3788
10		Overall width	b2(mm)	1495	1495	1580	1580	1580
11		Mast lowered height	h1(mm)	2294	2294	2950	2950	2950
12		Mast extended height	h4(mm)	3790	3790	6110	6110	6110
13		Overhead guard height	h6(mm)	2215	2215	2491	2491	2491
14	Seat height (center of gravity)	h7(mm)	/	/	1210	1210	1210	
15	Stacking aisle width	Ast(mm)	1500	1500	1600	1600	1600	
16	Standard values for working aisle widths(calculated)	Ast3(mm)	3245	3405	4015	4015	4335	
17	Pallet dimension	l6×b12	mm	1000×1000	1000×1000	1200×1200	1200×1200	1200×1200
18	Turning radius	Wa(mm)	1616	1775	2150	2150	2469	
19	Front overhang	mm	990	990	1061	1061	1061	
20	Track width, front (outside)	mm	1220	1220	1402	1402	1402	
21	Min. ground clearance	m2(mm)	25	25	10	10	10	
22	Wheelbase	Y(mm)	1350	1500	1764	1764	2084	
23	Sideshift range	mm	1230	1230	1240	1240	1240	
24	Fork regulating range	Min./Max.	b13(mm)	200-760	200-760	240—848	240—848	240—848
25	Speed	Travel(Laden)	km/h	10	10	10	10	10
26		Travel(Unladen)	km/h	10	10	10	10	10
27		Lifting(Laden)	mm/s	290	290	320	320	320
28		Lifting(Unladen)	mm/s	440	440	380	380	380
29	For rotating speed	Rotating(Laden)	s/180°	8	8	8	8	8
30	Sideshift speed	Laden	mm/s	150	150	150	150	150
31	Service brake			regenerative		hydraulic		
32	Parking brake			electric spring-loaded				
33	Service weight	incl.battery	kg	2630	2630	6820	6820	7635
34	Tyre	Front	mm	φ250 Polyurethane		φ285 Polyurethane		
35		Rear	mm	φ381 Polyurethane		φ400 Polyurethane		
36	Motor	drive	kw	2.5	2.5		10	
37		pump	kw	9.2	9.2		12	
38	Battery	standard	V/Ah	48V/210Ah	48V/310Ah	80V/500Ah	80V/500Ah	80V/700Ah
39		weight	Kg	400	520	1322	1322	1877
40	Controller	Type					AC	
41		Manufacturer					ZAPI	
42	Sound level at drive's ear according to EN 12053		dB(A)				73	
43	Steering type			Hydraulic Power Steering		Electronic power steering		
44	Operating pressure for attachment		Mpa		14.5		17.5	

## 0.7-1.5t wide view 2-stage mast

Lift height	Model	Load center	2500	3000	3500	4000	4500	5000	5500	6000	6500	7000	
Extended mast height (mm)	h4	FBT07-MJZ	500mm	3440	3790	4290	4840	5340	5840	6390	6890	-	-
		FBT10-MJZ	500mm	3440	3790	4290	4840	5340	5840	6390	6890	-	-
		FBT13-MJZ	600mm	3540	4040	4540	5090	5590	6090	6565	7065	7565	8065
		FBT13S-MJZE	600mm	3540	4040	4540	5090	5590	6090	6565	7065	7565	8065
		FBT15-MJZE	600mm	3540	4040	4540	5090	5590	6090	6565	7065	7565	8065
Mast lowered height (mm)	h1	FBT07-MJZ	500mm	2044	2294	2544	2844	3094	3344	3644	3894	-	-
		FBT10-MJZ	500mm	2044	2294	2544	2844	3094	3344	3644	3894	-	-
		FBT13-MJZ	600mm	2294	2544	2794	3094	3344	3594	3819	4069	4319	4569
		FBT13S-MJZE	600mm	2294	2544	2794	3094	3344	3594	3819	4069	4319	4569
		FBT15-MJZE	600mm	2294	2544	2794	3094	3344	3594	3819	4069	4319	4569
Free lift height (mm)	h2	FBT07-MJZ	500mm	0	0	0	0	0	0	0	0	-	-
		FBT10-MJZ	500mm	0	0	0	0	0	0	0	0	-	-
		FBT13-MJZ	600mm	0	0	0	0	0	0	0	0	0	0
		FBT13S-MJZE	600mm	0	0	0	0	0	0	0	0	0	0
		FBT15-MJZE	600mm	0	0	0	0	0	0	0	0	0	0
Load capacity (Kg)		FBT07-MJZ	500mm	700	700	700	700	650	600	450	300	-	-
		FBT10-MJZ	500mm	1000	1000	1000	1000	900	800	600	400	-	-
		FBT13-MJZ	600mm	1300	1300	1300	1300	1150	1050	950	850	750	650
		FBT13S-MJZE	600mm	1300	1300	1300	1300	1150	1050	950	850	750	650
		FBT15-MJZE	600mm	1500	1500	1500	1500	1400	1300	1200	1100	1000	900
Mast weight (Kg)		FBT07-MJZ	500mm	1047	1072	1122	1212	1262	1343	1400	1458	-	-
		FBT10-MJZ	500mm	1047	1072	1122	1212	1262	1343	1400	1458	-	-
		FBT13-MJZ	600mm	1732	1805	1878	2025	2098	2210	2442	2520	2598	2676
		FBT13S-MJZE	600mm	1732	1805	1878	2025	2098	2210	2442	2520	2598	2676
		FBT15-MJZE	600mm	1732	1805	1878	2025	2098	2210	2442	2520	2598	2676

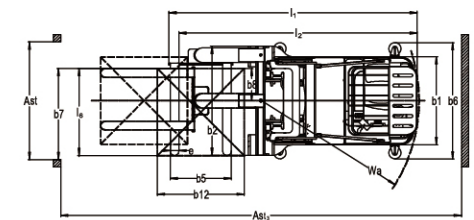
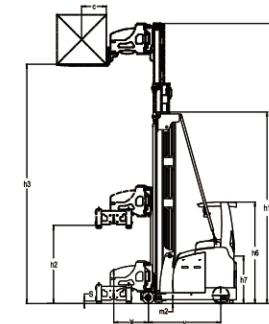
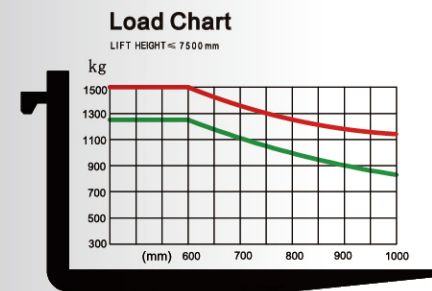



## 0.7-1.5t wide view full free 3-stage mast

Lift height	Model	Load center	4000	4500	5000	5500	6000	6500	7000	7500	8000	8500	9000	9500	10000	10500	11000	11500	12000	12500	12500	
Extended mast height (mm)	h4	FBT07-MJZ	500mm	4895	5395	5895	6395	6925	/	/	/	/	/	/	/	/	/	/	/	/	/	/
		FBT10-MJZ	500mm	4895	5395	5895	6395	6925	/	/	/	/	/	/	/	/	/	/	/	/	/	/
		FBT13-MJZ	600mm	/	/	/	6610	7105	7600	8095	8590	-	-	-	-	-	-	-	-	-	-	-
		FBT13-MJZE	600mm	/	/	/	6610	7105	7600	8095	8590	9085	9580	10075	10575	11070	-	-	-	-	-	-
		FBT13S-MJZE	600mm	/	/	/	6610	7105	7600	8095	8590	9085	9580	10075	10575	11070	-	-	-	-	-	-
		FBT15-MJZE	600mm	/	/	/	6610	7105	7600	8095	8590	9085	9580	10075	10575	11070	11565	12060	12555	13050	13545	14040
Mast lowered height (mm)	h1	FBT07-MJZ	500mm	2190	2355	2520	2735	2900	/	/	/	/	/	/	/	/	/	/	/	/	/	/
		FBT10-MJZ	500mm	2190	2355	2520	2735	2900	/	/	/	/	/	/	/	/	/	/	/	/	/	/
		FBT13-MJZ	600mm	/	/	/	2950	3115	3280	3445	3610	-	-	-	-	-	-	-	-	-	-	-
		FBT13-MJZE	600mm	/	/	/	2950	3115	3280	3445	3610	3775	3940	4105	4345	4510	-	-	-	-	-	-
		FBT13S-MJZE	600mm	/	/	/	2950	3115	3280	3445	3610	3775	3940	4105	4345	4510	-	-	-	-	-	-
		FBT15-MJZE	600mm	/	/	/	2950	3115	3280	3445	3610	3775	3940	4105	4345	4510	4675	4840	5005	5170	5335	5500
Free lift height (mm)	h2	FBT07-MJZ	500mm	1365	1535	1705	1875	2045	/	/	/	/	/	/	/	/	/	/	/	/	/	/
		FBT10-MJZ	500mm	1365	1535	1705	1875	2045	/	/	/	/	/	/	/	/	/	/	/	/	/	/
		FBT13-MJZ	600mm	/	/	/	1840	2010	2180	2350	2520	-	-	-	-	-	-	-	-	-	-	-
		FBT13-MJZE	600mm	/	/	/	1840	2010	2180	2350	2520	2690	2860	3030	3270	3440	-	-	-	-	-	-
		FBT13S-MJZE	600mm	/	/	/	1840	2010	2180	2350	2520	2690	2860	3030	3270	3440	-	-	-	-	-	-
		FBT15-MJZE	600mm	/	/	/	1840	2010	2180	2350	2520	2690	2860	3030	3270	3440	3610	3780	3950	4120	4290	4460
Load capacity (Kg)	FBT07-MJZ	500mm	700	650	600	450	300	/	/	/	/	/	/	/	/	/	/	/	/	/	/	
	FBT10-MJZ	500mm	1000	900	800	600	400	200	/	/	/	/	/	/	/	/	/	/	/	/	/	
	FBT13-MJZ	600mm	/	/	/	1250	1250	1250														
	FBT13-MJZE	600mm	/	/	/	1300	1300	1300	1300	1300	1100	950	800	650	500	-	-	-	-	-	-	
	FBT13S-MJZE	600mm	/	/	/	1300	1300	1300	1300	1300	1100	950	800	650	500	-	-	-	-	-	-	
	FBT15-MJZE	600mm	/	/	/	1500	1500	1500	1400	1320	1250	1170	1100	1020	950	870	800	720	650	580	500	
Mast weight (Kg)	FBT07-MJZ	500mm	1481	1582	1575	1637	1684	/	/	/	/	/	/	/	/	/	/	/	/	/	/	
	FBT10-MJZ	500mm	1481	1582	1575	1637	1684	/	/	/	/	/	/	/	/	/	/	/	/	/	/	
	FBT13-MJZ	600mm	/	/	/	2745	2820	2935	3090	3185	-	-	-	-	-	-	-	-	-	-	-	
	FBT13-MJZE	600mm	/	/	/	2745	2820	2935	3090	3185	3275	3360	3450	3660	3747	-	-	-	-	-	-	
	FBT13S-MJZE	600mm	/	/	/	2745	2820	2935	3090	3185	3275	3360	3450	3660	3747	-	-	-	-	-	-	
	FBT15-MJZE	600mm	/	/	/	2850	2925	3040	3195	3290	3380	3465	3555	3765	3852	3939	4026	4133	4200	4287	4371	

